

Courses up the  
Mannings River  
S 58 W 95  
S 69 W 67  
West 28  
N 72 W 57  
N 54 W 36  
N 39 W 60  
N 35 W 32  
N 19 W 118 1/2  
N 27 W 88  
58 1/2

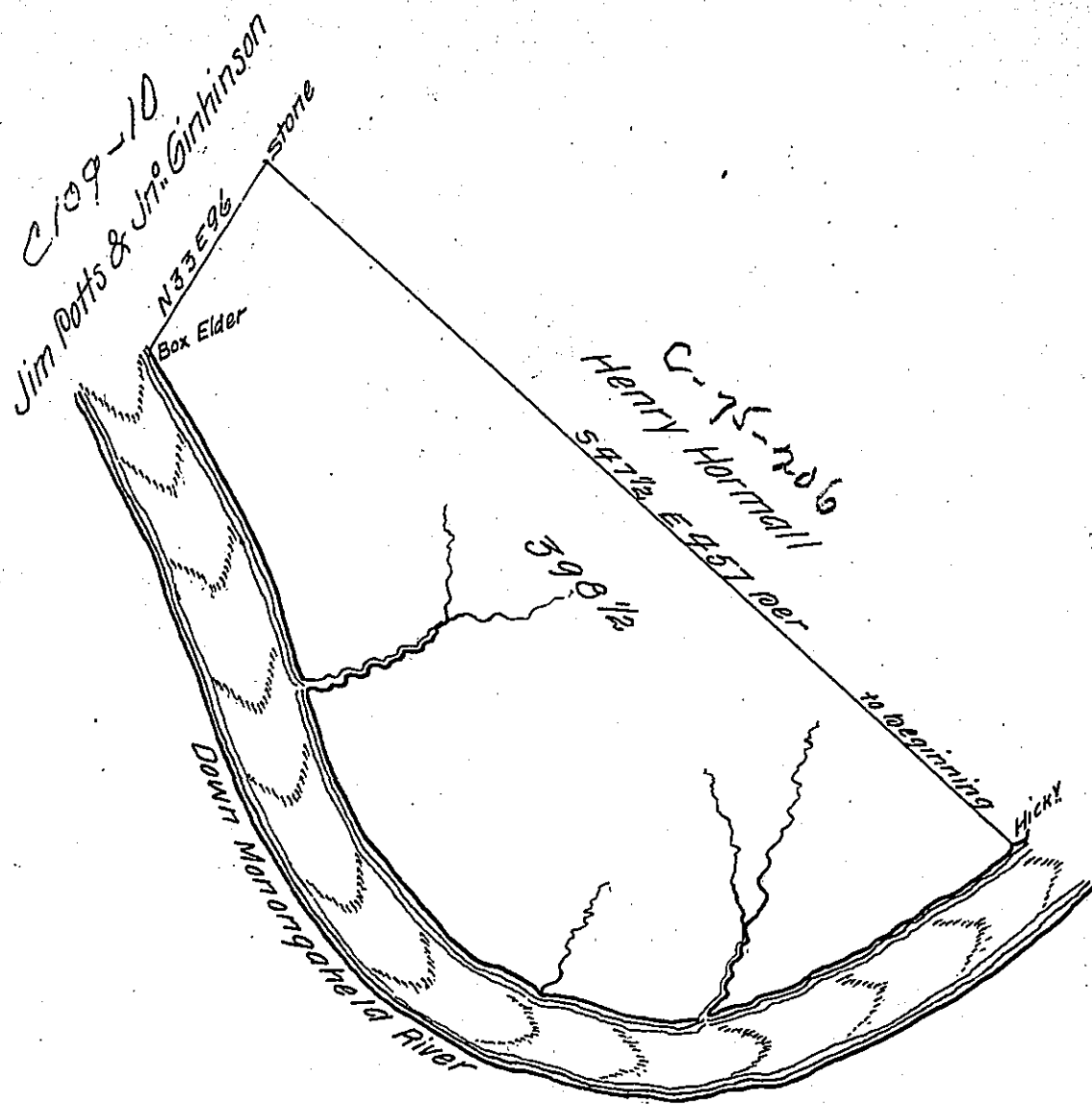

The above is a draught of a survey made June 1<sup>st</sup> 1786 in pursuance of a warrant granted John Harmall Feb<sup>y</sup> 16<sup>th</sup> 1786 call<sup>d</sup> Garland containing ~~598 1/2~~ acres together with six p<sup>er</sup> cent allowance for Roads &c.

The above was survey'd on a Virgin's certificate for s<sup>r</sup> Harmall which proves (upon examination) not good. you will therefore please to except this return in place of the one you have for s<sup>r</sup> Harmall which may be returned to me if thought prudent

John Lukens Esq<sup>t</sup>

S<sup>t</sup>. G<sup>o</sup>. State Penns<sup>l</sup>.

Jm<sup>o</sup> Hoge D.S.

IN TESTIMONY that the above is a copy of the original remaining on file in the Department of Internal Affairs of Pennsylvania, made conformably to an Act of Assembly approved the 16th day of February, 1833, I have hereunto set my Hand and caused the Seal of said Department to be affixed at Harrisburg, this twenty sixth day of January 1905

*Grace A. Brown*  
Secretary of Internal Affairs.